



## CEDARSHED INSTRUCTIONS



### MONTROSE- SHINGLE ROOF

Base size: 3000mm x 2490mm deep

# MONTROSE

## Tools Required:

- Battery Drill
- Riveter
- Hammer
- Tape Measure
- Ladder
- Skillsaw
- Level
- Screwdriver - Flat
- 3/8 Hex Drive bit
- Drill Bit 3.2mm

## Before you start:

- Read all instructions carefully.
- Identify all parts and check quantities against checklist.

## Safety:

- Do not attempt to build your shed in high winds.
- Beware of sharp edges.
- Protect your eyes and ears.
- Use electric tools with care. Use a Safety Trip Switch.
- It is easier and quicker if this shed is erected by two people.

## Select your site:

- Your shed must be level. Achieve this by either levelling the ground or by using blocks.

# MONTROSE PARTS LIST

	Description	Size	Qty		
<b>PACK ONE - ROOF</b>	Shingle Roof Panels (L/H)	1550 x 1425	2	<input type="checkbox"/>	
	Shingle Roof Panels (R/H)	1550 x 1425	2	<input type="checkbox"/>	
<b>PACK TWO - SHED</b>	Standard Door	895 x 1780	1	<input type="checkbox"/>	
	Std Wall Panels	900 x 1937	3	<input type="checkbox"/>	
	Std Wall Panels	1200 x 1937	2	<input type="checkbox"/>	
	End Wall Panels (L/H)	1200 x 2460	2	<input type="checkbox"/>	
	End Wall Panels (R/H)	1200 x 2460	2	<input type="checkbox"/>	
	Cedar Corner Clashings	65 x 17 x 1962	4	<input type="checkbox"/>	
	30 x 17 Std Cedarbead	30 x 17 x 1937	2	<input type="checkbox"/>	
	15 x 17 Std Cedarbead	15 x 17 x 1937	6	<input type="checkbox"/>	
	30 x 17 Gable Cedarbead	30 x 17 x 2465	2	<input type="checkbox"/>	
	Bargeboards	90 x 17 x 1480	4	<input type="checkbox"/>	
	Door Stop	45 x 45 x 900	1	<input type="checkbox"/>	
	Door Lintel	167 x 900	1	<input type="checkbox"/>	
	Weatherstrip	50mm x 20m Roll	1	<input type="checkbox"/>	
	Soakers	240 x 50mm	14	<input type="checkbox"/>	
	Diamonds	230 x 95 x 17	2	<input type="checkbox"/>	
	Rafter Gussets	400 x 98 x 12	6	<input type="checkbox"/>	
	Silicone Tubes	300g	2	<input type="checkbox"/>	
	Ridge Flashings	240 x 1700	2	<input type="checkbox"/>	
	Collar Ties	45 x 45 x 1280	3	<input type="checkbox"/>	
	Temporary Spacer	45 x 45 x 2490	1	<input type="checkbox"/>	
	20mm Packer	20 x 45 x 1720	1	<input type="checkbox"/>	
	<b>Hardware Pack</b>				
		Tek Screws	14G x 75mm, CL4	60	<input type="checkbox"/>
		Framing Nails	75 x 3.15mm	50	<input type="checkbox"/>
		Bead Nails	50 x 2.5mm	125	<input type="checkbox"/>
		Clouts	30 x 2.5mm	120	<input type="checkbox"/>
		Colour Rivets	3.2 x 8.2mm	4	<input type="checkbox"/>
		Door Handle		1	<input type="checkbox"/>
		Door Latch		1	<input type="checkbox"/>
		Door Handle Screws	3/16 x 2.5"	2	<input type="checkbox"/>
		Touch Up Paint & Brush		1	<input type="checkbox"/>
	Instructions		1	<input type="checkbox"/>	
<b>PACK THREE - STIFFENERS (&amp; FLOOR if required)</b>	Top plate stiffeners	45 x 45 x 3000	2	<input type="checkbox"/>	
	Floor Joists	70 x 45 x 2990	5	<input type="checkbox"/>	
	Floor Boards	150 x 19 x 2485	20	<input type="checkbox"/>	
	Floor Nails	50 x 2.5mm	200	<input type="checkbox"/>	

Packed by:

Date: / /



# MONTROSE FLOOR - OPTIONAL

Step 1: Lay out floor joists, spacing them evenly as shown. Using 50mm flooring nails, nail a floor board on each end, ensuring ends are flush with joists. Make sure floor is level and joists are supported at 900mm centres.



Step 2: Lay out remaining floor boards. Measure diagonals to ensure measurements are equal (i.e. floor is square). Rip down last floor board to suit gap, and nail off floor with 50mm flooring nails (10 nails per board).



Step 3: Nail plastic weather strip to edge of floor on all four sides, with 30mm clouts, (approx 5 nails per side) ensuring top edge is flush with top of floor. This isn't required if shed is on a concrete base.



Step 4: Unpack panels and identify wall and door positions as per plan on following page.

Select two panels that go either side of a corner (gable and standard panel) and stand together.



# MONTROSE CONCRETE FLOOR - OPTIONAL

## Building a Raised Concrete Base

**Step 1:** Establish size of shed and excavate sufficient area. Remember to allow for rear roof overhang up to 150mm, and 120mm on each end.

**Step 2:** Ensure that the base substrate is compacted firmly. We suggest that the slab should be 80mm thick in the middle and 100mm thick around the edges.

**Step 3:** Lay boxing to the required size, the raised slab size should be 2985 x 2475mm and at least 30mm above the ground line.

**Step 4:** Lay plastic sheeting if required. Plastic sheeting under slab will prevent moisture coming through from underneath.

**Step 5:** Pour concrete and screed flush

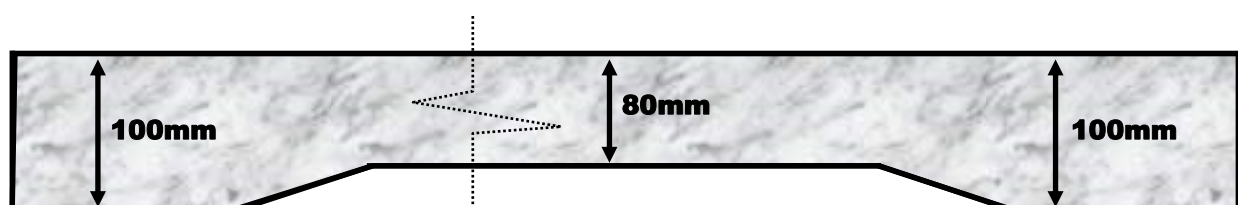

# MONTROSE WALL PLAN

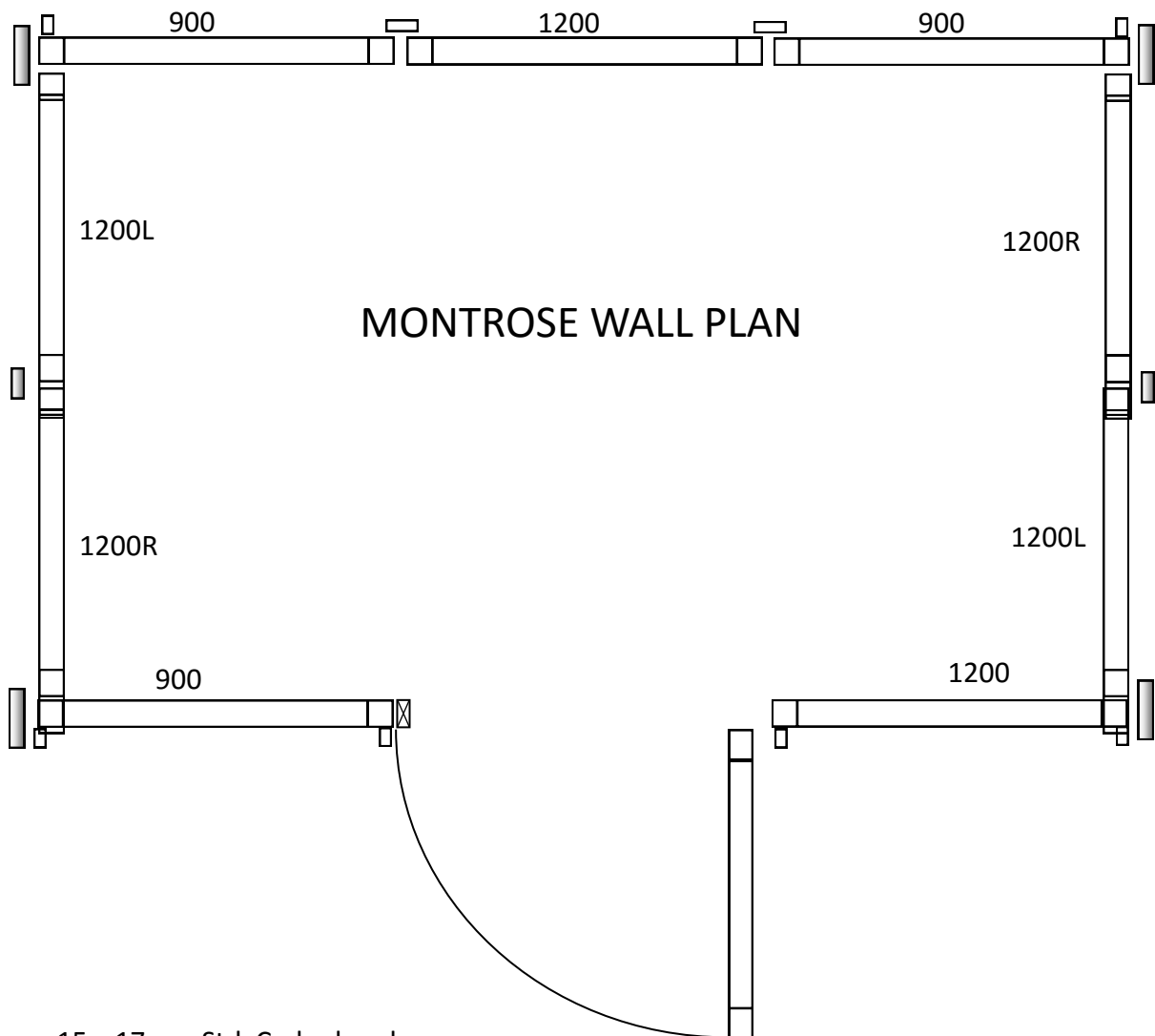

15 x 17mm Std Cedar bead 

30 x 17mm Std Cedar bead 

30 x 17mm Gable Cedar bead 

Corner Clashing 

45 x 20mm Packer 



# MONTROSE WALLS

Step 5: Screw wall panels together using 75mm tek screws (3 per standard join, 4 per gable join), ensuring end wall panels are inside side wall panels as per wall plan.

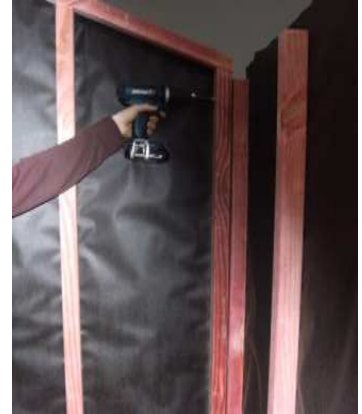

Step 6: Silicone edge of weatherboards on standing panel and nail on cedar beads with 5 x bead nails. (Refer to wall plan for correct beads).

Make sure bead is properly sealed to avoid leaks.

Note: On standard beads only, top of bead is bevelled to allow for slope of roof.



Step 7: Silicone and nail remaining beads on each panel. Screw panels together using 3 tek Screws per join and 4 on the longer joins on gable end panels.



# MONTROSE TOP LINTEL

Step 8: Using 4 x 75mm tek screws screw door lintel to studs. Ensure outside cedar weatherboard on lintel is flush with weatherboards each side.

Door Lintel shown from inside



Door Lintel shown from outside.



# MONTROSE TOP STIFFENER

Step 9: Using 75mm framing nails, nail both top plate stiffeners into standard wall panels studs, as shown using 2 nails per stud (1 nail per stud at panel joins). Ensure ends are flush before nailing.



Step 10: Using 30mm clouts nail top cedar boards to stiffeners (2-3 per board). Pre-drill holes to stop boards from splitting.





# MONTROSE CORNER CLASHINGS

Step 11: Silicone and nail 15 x 17mm beads on all corners as shown using 5 x 50mm bead nails, per bead.



Step 12: Silicone and nail corner clashings on all corners as shown using 5 x bead nails per clashing.

Silicone both edges of clashing to ensure this doesn't leak.



# MONTROSE ROOF

Step 13: Ensure shed is square, by measuring diagonals at top corner of wall panels.

Temporarily screw timber spacer between front and back walls to ensure top of walls are correct distance apart.

Step 14: Note—shed shown has 1 panel per side. Montrose has 2 panels per side. Place 1 back and 1 front panel in position.



Step 15: Using 75mm tek screws, screw roof panels into end wall panels, (2 screws per panel), ensuring end of rafter lines up with centre of gable panel.

Repeat with remaining 2 panels.



# MONTROSE ROOF

Step 16: Using 4 x 75mm Tek screws, screw roof panels together through rafters as shown.

(2 screws per rafter)



Step 17: Using 12 x 75mm framing nails, nail roof rafters to front and back top plate stiffeners. Pre-drill if necessary.



Step 18: Using 6 x 75mm tek screws, screw 3x collar ties to underside of rafters. Pre-drill before screwing if necessary.



Step 19: Attach a plywood gusset to each side of rafters as shown using 8 x 30mm clouts per side.



Step 20: Rivet ridge flashings together and attach to roof panels with 30mm clouts nailing into top purlin at approx 300mm centres.



# MONTROSE ROOF

Step 21: Slide roof soakers in position on all joints, starting at the bottom row of shingles and working up.



Step 22: Nail using 50mm nails, above the bottom of the next row of shingles.



Step 23: Remove temporary timber spacer between front and back walls.

# MONTROSE BARGE

Step 24: Nail barge boards to ends of purlins, using 50mm bead nails. (1 nail per purlin).

Nail diamonds to barges with 2 x 50mm bead nails.



# MONTROSE DOOR

Step 25: Fit Door Stop in door way. Check all wall panels are straight and panels either side of doorway are tight against door stop. Screw panels to floor using 1 x 75mm tek screw per panel. Screw near the panel joins, where possible.

Nail door stop to floor using 3 x 75mm framing nails.



Step 26: Fit Door in position as shown.



Step 27: Using 3 x 75mm tek screws, screw door stud to panel ensuring height is correct.

Check that door opens and closes correctly and height is correct.



Fit handle as shown. Attach with 2 x handle screws. Attach and tighten latch to square shaft.

Using 5 x 50mm beading nails, nail 20mm packer onto side of door opening as shown in Wall plan on pg. 5.





# MONTROSE

Your shed is now complete. You may protect Cedar by staining cedar weatherboards if required.



# CEDAR SHED WARRANTY

## GUARANTEE TO CUSTOMER

Congratulations on purchasing a quality New Zealand made Cedar Shed manufactured by Riverlea Group Limited. With proper care and attention this product will offer you many years of use.

## WARRANTY ON METAL CLADDING

Your new shed is guaranteed for the benefit of the original purchaser, against defective material or faulty workmanship for **fifteen years** from date of purchase. Riverlea Group Limited will, at its discretion, replace or repair any faulty or defective materials within this time on condition that due care and maintenance has been carried out as detailed below.

## TERMS AND CONDITIONS

This warranty does not cover Cedar sheds with steel roofing if it is installed outside the inland corrosion zone or areas where the corrosion rate is more than 200g/m<sup>2</sup> (as published by BRANZ)

1. The warranty does not cover damage or failure due to improper assembly.
2. This warranty does not cover damage through force majeure or other cause beyond the control of Riverlea Group Limited.
3. This warranty is void if maintenance as detailed below and in the assembly manual has not been adhered to.
4. This warranty does not cover natural variations, expansion, contractions as can be reasonably expected from a timber product.

Painting or coating of your Cedar Shed with a dark colour will cause increased timber temperature and movement which will render this warranty null and void.

Beyond the exclusions above, Riverlea Group Limited will repair or replace the damaged or faulty product. The balance of the original warranty will cover any repaired or replaced material. Riverlea Group Limited will not be liable for any consequential loss or damage, labour or transport costs. All claims must be made within 21 days of discovery.

## MAINTENANCE

The following are the minimum maintenance requirements for Cedar Sheds manufactured by Riverlea Group Limited. Please refer to your assembly manual for more details.

Immediately coat all cedar walling cladding with "Endurance Cedar Wall Protector". Cedar walls are to be regularly recoated according to application instructions on the product packaging.

Immediately coat all cedar shingle roofing with "Endurance Cedar Shingle Protector" Cedar shingles are to be regularly recoated according to application instructions on the product packaging.

All steel roofing is to be kept clean and free of debris and washed annually with a hose and soft brush.

Timber floors, where supplied are to be kept out of direct water contact or runoff

The above guidelines will guarantee you a superior Cedar Shed that will offer you many years of outstanding usefulness.

# WARRANTY REGISTRATION

Please visit <http://www.riverleagroup.co.nz/warranty-garden-sheds> to validate the Warranty on your shed.

Click on the Warranty Registration Link and complete all details.

If you are unable to access the computer, please phone us on 0800 438 274 and one of the customer services team will help you to activate the warranty on your garden shed.

*Many thanks, from the Team at Riverlea Group.*







